

## RESOLUTION #47-16

### 2016 Revenue Fund

**BE IT RESOLVED**, by the South Monmouth Regional Sewerage Authority that Revenue Fund Requisition #05-16 in the total amount of \$281,227.07 is hereby approved for transfer as follows:

1. That \$146,314.84 is transferred from the Revenue Fund to the Operating Fund in satisfaction of all approved bills attached hereto and made a part thereof as of this date.
2. That \$134,912.23 is transferred from the Revenue Fund to the Payroll Fund to reimburse the Authority for the prior month's gross payroll and employer payroll taxes.

**BE IT FURTHER RESOLVED**, that bills listed in the aforesaid Revenue Fund Requisition be and are hereby approved for payment from the Operating and Payroll Funds.

CERTIFIED TO BE A TRUE COPY OF A RESOLUTION DULY ADOPTED BY THE SOUTH MONMOUTH REGIONAL SEWERAGE AUTHORITY AT ITS REGULAR OPEN PUBLIC MEETING ON 05-12-16.

BY: Mary L. Burne  
MARY-L. BURNE - SECRETARY

## 2016 REVENUE FUND REQUISITION

Requisition #05-16  
Total of Requisition: \$281,227.07  
Date: May 12, 2016

### CERTIFICATION

I hereby certify, on behalf of the South Monmouth Regional Sewerage Authority, that the expenses listed on the attached Revenue Fund Requisition have been approved for payment by the Authority. I further certify that (1) the expenses listed are reasonable, (2) the amounts being requisitioned for expenses plus amounts previously requisitioned during the present fiscal quarter for expenses classifiable in the same accounts do not exceed the amounts budgeted for those accounts for the quarter in the current budget on file with the Trustee.

SOUTH MONMOUTH REGIONAL SEWERAGE AUTHORITY

BY:



THOMAS B. NICOL - CHAIRMAN

**SOUTH MONMOUTH REGIONAL SEWERAGE AUTHORITY**  
**Supplemental Information to Requisition # 05 - 16**  
**11-May-16**

**Total amount of checks** **84,748.84**

Plus:

State Health Benefit Programs - Medical	34,326.72
State Health Benefit Programs - Rx	8,547.78
State Health Benefit Programs - Retirees	16,143.80
BC/BS - Dental Program	1,902.20
VSP - Eye Care	642.00

Re-imburse SMRSA for April, 2016 Gross Payroll	125,564.28
Re-imburse SMRSA for April, 2016 Employer Portion Federal Payroll Taxes	9,347.95

SUB - TOTAL 196,474.73

Adjustments:

Misc. Adjustment	3.50
	<u>0.00</u>

SUB - TOTAL 3.50

**REQUESTED AMOUNT OF WIRE TRANSFER** **281,227.07**

**WIRE INSTRUCTIONS:**

A/P Checks	84,748.84
SHBP	59,018.30
Dental/ Vision	2,544.20
Adjustments	<u>3.50</u>

**TO OPERATING ACCOUNT** **146,314.84**

Payroll & Related Taxes	134,912.23
Adjustments	<u>0.00</u>

**TO PAYROLL ACCOUNT** **134,912.23**

**REQUETSED AMOUNT OF WIRE TRANSFER** **281,227.07**

0.00

From of Checking Accts: OPERATING to OPERATING Range of Check Ids: 15953 to 16002  
Report Type: All Checks Report Format: Super Condensed Check Type: Computer: Y Manual: Y Dir Deposit: Y

Check #	Check Date	Vendor	Amount Paid	Reconciled/Void Ref Num
15953	05/19/16	ACCURA50 ACCURATE WASTE REMOVAL SERVICE	9,114.50	165
15954	05/19/16	ADPINC50 ADP, LLC	1,154.52	165
15955	05/19/16	ALLISO50 ALLISON PEST CONTROL	60.00	165
15956	05/19/16	AMERIC80 AMERICAN WATER WORKS ASSO	86.00	165
15957	05/19/16	ASHOME50 A'S HOME & GARDEN CENTER	32.39	165
15958	05/19/16	BELMAR33 BELMAR PAINT	4.31	165
15959	05/19/16	BIOTR50 BIOTRIAD ENVIRONMENTAL	1,050.00	165
15960	05/19/16	BOROU48 BOROUGH OF MANASQUAN	137.00	165
15961	05/19/16	BOROU84 BOROUGH OF SPRING LAKE HT	243.75	165
15962	05/19/16	CAPITAL1 Capital One N.A.	2,455.29	165
15963	05/19/16	COAST50 COASTAL SOLUTIONS INC.	524.60	165
15964	05/19/16	CRYSTA50 CRYSTAL SPRINGS	53.08	165
15965	05/19/16	ENVIRO33 ENVIRONMENTAL RESOURCE ASSOC	497.00	165
15966	05/19/16	ESSERV50 Essex Service Corporation	829.44	165
15967	05/19/16	GRAING50 GRAINGER INC	3,432.66	165
15968	05/19/16	JAEGER50 JAEGER LUMBER	170.72	165
15969	05/19/16	JERSEY16 JERSEY CENTRAL POWER & LI	5,815.39	165
15970	05/19/16	KRAUSE50 Ryan Krause	184.88	165
15971	05/19/16	LOWES055 LOWE'S BUSINESS ACCT/GECRB	12.32	165
15972	05/19/16	MANNAB50 MANNA & BONELLO P.A.	1,937.50	165
15973	05/19/16	MCMAST50 MCMASTER-CARR	126.49	165
15974	05/19/16	MILLER50 MILLER, SUSAN	540.45	165
15975	05/19/16	MONARCH5 MONARACH ELECTRIC COMPANY	150.43	165
15976	05/19/16	MONMOU64 MONMOUTH TELECOM	444.10	165
15977	05/19/16	NJNATL33 NJ NAT'L GAS	909.60	165
15978	05/19/16	ONECAL55 ONE CALL CONCEPTS	220.00	165
15979	05/19/16	PASSAI50 PASSAIC VALLEY SEWERAGE	4,275.00	165
15980	05/19/16	PATROC50 PMR Building Maintenance, LLC	340.00	165
15981	05/19/16	PENN50 Penn Valley Pump	436.50	165
15982	05/19/16	QLABO50 QC/EUROFINS QC, Inc.	1,021.00	165
15983	05/19/16	RUPPEL66 RUPPEL, MICHAEL	130.00	165
15984	05/19/16	SEABO66 SEABOARD WELDING SUPPLY	75.00	165
15985	05/19/16	SEAGIR50 SEA GIRT MEDICAL GROUP	250.00	165
15986	05/19/16	SHAFTS50 SHAFTS & SLEEVES	17,860.00	165
15987	05/19/16	SHINN50 Shinn Cranes	760.00	165
15988	05/19/16	STONYB55 STONY BROOK REGIONAL	10,045.00	165
15989	05/19/16	SUBURB50 SUBURBAN PROPANE	12.00	165
15990	05/19/16	TAYLOR50 TAYLOR HARDWARE STORE	83.51	165
15991	05/19/16	UNIVAR50 UNIVAR USA INC	15,051.81	165
15992	05/19/16	VANWIC50 VAN WICKLE AUTO SUPPLY	265.92	165
15993	05/19/16	VERIWIRE Verizon Wireless	846.70	165
15994	05/19/16	VERIZO25 VERIZON	636.35	165
15995	05/19/16	WALLTW50 WALL TWP BUR OF FIRE PREV	779.00	165
15996	05/19/16	WASTEM50 WASTE MANAGEMENT OF NJ	360.31	165
15997	05/19/16	WATERE33 WATER ENVIRONMENT FED	165.00	165
15998	05/19/16	WATERE66 WATER ENVIRONMENT FED.	103.00	165
15999	05/19/16	WILLEV50 WILLEVER, CHARLES	195.00	165
16000	05/19/16	WORKNG50 WORK 'N GEAR	153.00	165
16001	05/19/16	WRIGHT50 WEX Bank - wrightExpress	692.87	165
16002	05/19/16	XEROXC50 XEROX CORP.	25.45	165

---

Check #	Check Date	Vendor	Amount Paid	Reconciled/Void	Ref Num
---------	------------	--------	-------------	-----------------	---------

---

16002		XEROX CORP.			
			Continued		
Report Totals			<u>Amount Paid</u>	<u>Amount Void</u>	
		Checks:	50	0	
		Direct Deposit:	0	0	
		Total:	50	0	
			84,748.84	0.00	
			0.00	0.00	
			84,748.84	0.00	

---

Totals by Year-Fund Fund Description	Fund	Expend Total	Revenue Total	G/L Total	Total
	6-01	84,748.84	0.00	0.00	84,748.84
Total of All Funds:		<u>84,748.84</u>	<u>0.00</u>	<u>0.00</u>	<u>84,748.84</u>

**RESOLUTION #48-16**

**Construction Project Fund**

**BE IT RESOLVED**, by the South Monmouth Regional Sewerage Authority that bills listed in Construction Project Fund Req. #05-16 and totaling \$210,634.64 be and are hereby approved for payment from the Construction Project Fund.

CERTIFIED TO BE A TRUE COPY OF A RESOLUTION  
DULY ADOPTED BY THE SOUTH MONMOUTH  
REGIONAL SEWERAGE AUTHORITY AT ITS REGULAR  
OPEN PUBLIC MEETING ON 05-12-16.

  
\_\_\_\_\_  
MARY L. BURNE - SECRETARY

**SOUTH MONMOUTH REGIONAL SEWERAGE AUTHORITY  
CONSTRUCTION PROJECT FUND**

Requisition No. CPF #05-16  
Date: May 12, 2016

<u>Payee and Address</u>	<u>Character of Obligation</u>	<u>Amount</u>
Allied Construction Group Inc. 499 Washington Road Parlin, NJ 08859 Attn: Matthew Marcinczyk	Belmar Pump Station Upgrades Resolution #56-15 Pay Estimate #5	\$ 210,109.06
T&M Associates P.O. Box 828 Red Bank, NJ 07701 Attn: Richard Crane	On Call Construction Belmar PS Resolution #57-15 DAC297833 dtd 04/13/2016	\$ <u>525.58</u>
	<b>TOTAL</b>	<b>\$ 210,634.64</b>

IN CONNECTION THEREWITH, WE CERTIFY THAT THE ABOVE OBLIGATIONS TO BE PAID WERE PROPERLY INCURRED BY THE AUTHORITY AND ARE PROPER CHARGES AGAINST THE CONSTRUCTION FUNDS. THE AMOUNTS TO BE PAID BY THIS REQUISITION ARE DUE AND UNPAID AND THERE ARE NO LIENS OR OTHER CLAIMS AFFECTING THE RIGHT TO PAYMENT WHICH SHOULD BE SATISFIED AND DISCHARGED BEFORE PAYMENT IS MADE OR WHICH WILL NOT BE DISCHARGED BY THIS PAYMENT.

SOUTH MONMOUTH REGIONAL SEWERAGE AUTHORITY

BY: \_\_\_\_\_

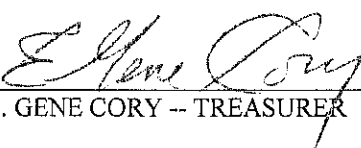
  
E. GENE CORY -- TREASURER



## RESOLUTION # 49-16

### Inter-local Agreement Between the Borough of Spring Lake and the South Monmouth Regional Sewerage Authority

**WHEREAS**, at an Open Public Meeting on August 14, 2014, the Board of Commissioners of the South Monmouth Regional Sewerage Authority unanimously approved Resolution #60-14 authorizing the replacement of the Pitney Avenue Pumping Station located in the Borough of Spring Lake; and

**WHEREAS**, the scope of work for this project included site work and landscaping; and

**WHEREAS**, the South Monmouth Regional Sewerage Authority has installed and completed all of the plantings pursuant to the plans and specifications contained therein; and

**WHEREAS**, the Borough of Spring Lake has indicated they would prefer alternate landscaping on a more elaborate basis utilizing the property they own along the perimeter of the pump station; and

**WHEREAS**, the Borough of Spring Lake and the Authority have arrived at an agreement whereby in consideration of a one-time SMRSA monetary consideration of \$10,000.00 to the Borough of Spring Lake, the Authority is released of all landscaping obligations of the pump station and the Borough of Spring Lake shall be responsible for the replacement and maintenance of all landscaping outside the perimeter fence in accordance with the agreed upon landscaping plan a copy of which is attached hereto and made a part thereof (Attachment A).

**NOW, THEREFORE, BE IT RESOLVED** by the South Monmouth Regional Sewerage Authority that:

1. The Executive Director is herein authorized to execute any and all documents including but not limited to said Inter-local Agreement, a copy of which is attached hereto and made a part thereof on behalf of the Authority with the Borough of Spring Lake.

**NOW THEREFORE BE IT FURTHER RESOLVED** by the South Monmouth Regional Sewerage Authority that the statements contained in the foregoing preamble be and are hereby incorporated into this Resolution as if more fully set forth herein at length.

CERTIFIED TO BE A TRUE COPY OF A RESOLUTION DULY ADOPTED BY THE SOUTH MONMOUTH REGIONAL SEWERAGE AUTHORITY AT ITS REGULAR OPEN PUBLIC MEETING ON 05-12-16.

  
MARY L. BURNE - SECRETARY

**INTER-LOCAL AGREEMENT BETWEEN THE BOROUGH OF SPRING LAKE,  
AND THE SOUTH MONMOUTH REGIONAL SEWERAGE AUTHORITY**

**THIS AGREEMENT**, made the 10 day of May, 2016, by and between **THE BOROUGH OF SPRING LAKE**, with offices located at 423 Warren Avenue, Spring Lake, New Jersey, and **THE SOUTH MONMOUTH REGIONAL SEWERAGE AUTHORITY**, with offices located at 1235 18<sup>th</sup> Avenue, Belmar, New Jersey; and

**WITNESSTH**

**WHEREAS**, the South Monmouth Regional Sewerage Authority (herein referred to as the SMRSA) owns and operates a sewer pump station commonly known as the Pitney Avenue Pump Station located on South Blvd. within the Borough of Spring Lake; and

**WHEREAS**, Said pump station has recently been replaced pursuant to a Capital Improvements project review of the Spring Lake Planning Board; and

**WHEREAS**, Pursuant to said review, there were certain obligations by SMRSA to landscape around said property; and

**WHEREAS**, SMRSA had installed all of the plantings pursuant to the plans and specifications approved in the Capital Improvements Project Review; and

**WHEREAS**, Said landscaping has been commenced and the Borough of Spring Lake has indicated that they would seek to do alternate landscaping in a more elaborate basis, utilizing other property it owns along the perimeter of the pump station.

**NOW, THEREFORE, BE IT AGREED**, by and between the Borough of Spring Lake and the South Monmouth Regional Sewerage Authority:

1. That the landscaping of the Pitney Avenue Pump Station located on South Blvd. shall no longer be the obligation of SMRSA. All landscaping at the property outside the perimeter fence shall be undertaken by the Borough of Spring Lake.
2. Upon receipt by the SMRSA of this Inter-local Agreement signed by authorized representatives of the Borough of Spring Lake, the SMRSA will make a one-time payment in the amount of Ten Thousand (\$10,000.00) Dollars to the Borough of Spring Lake for the release of all obligations pertaining to the landscaping at and around the pump station commonly known as Pitney Avenue.
3. The Borough of Spring Lake shall be responsible for the maintenance and replacement of all landscaping outside the perimeter fence of the pump station as set forth in the site plans heretofore exchanged.

IN WITNESS WHEREOF, the parties hereto have set their hands and seals this 16 day of May 2016.

ATTEST:

BOROUGH OF SPRING LAKE

Dina Techerky

BY: Joseph Dwyer

SOUTH MONMOUTH REGIONAL  
SEWERAGE AUTHORITY

[Signature]

BY: [Signature]

ATTACHMENT A

QTY	SYM	SYMBOL	COMMON NAME	COND	SIZE
18	18	PALE THURBERG	HAWAIIAN BLACK PINE	BAR	1 1/2" x 1/2" OIL
6	18	LEAF CLAR	CHRISTMAS TREE	CONTAINER	2 GALLON
3	18	SPERMATOPHYTES	AND CEDAR	CONTAINER	2 GALLON
1	18	PERENNIALS AND ORNAMENTAL GRASSES	PERENNIAL EVERGREEN	CONTAINER	2 GALLON
2	18	HERBACEOUS PERENNIALS	SAVILE	CONTAINER	1 GALLON
1	18	HERBACEOUS PERENNIALS	SAVILE	CONTAINER	1 GALLON
30	18	ARBOREOUS PLANTS	SPANBURG	CONTAINER	3-1/2"

EXIST BELOW 4' MIN - P. 101  
 NO ADDITIONAL TREES MAY  
 BE PLANTED NEAR PUMPING STATION  
 - NO ADDITIONAL PLANTINGS  
 WITHIN FACED AREA

- GENERAL NOTES**
- P-1. ALL TREES SHALL BE UNIFORM AND WELL-SHAPED SPECIMENS
  - P-2. ALL PLANTING BEDS AND SANDS SHALL HAVE A 3" DEPTH SUEDE
  - P-3. ALL PLANTING BEDS AND SANDS SHALL HAVE A 3" DEPTH SUEDE
  - P-4. ALL PLANTING BEDS AND SANDS SHALL HAVE A 3" DEPTH SUEDE
  - P-5. FOR LIGHT AND MEDIUM SIZE TREES SEE SPECIFICATIONS.

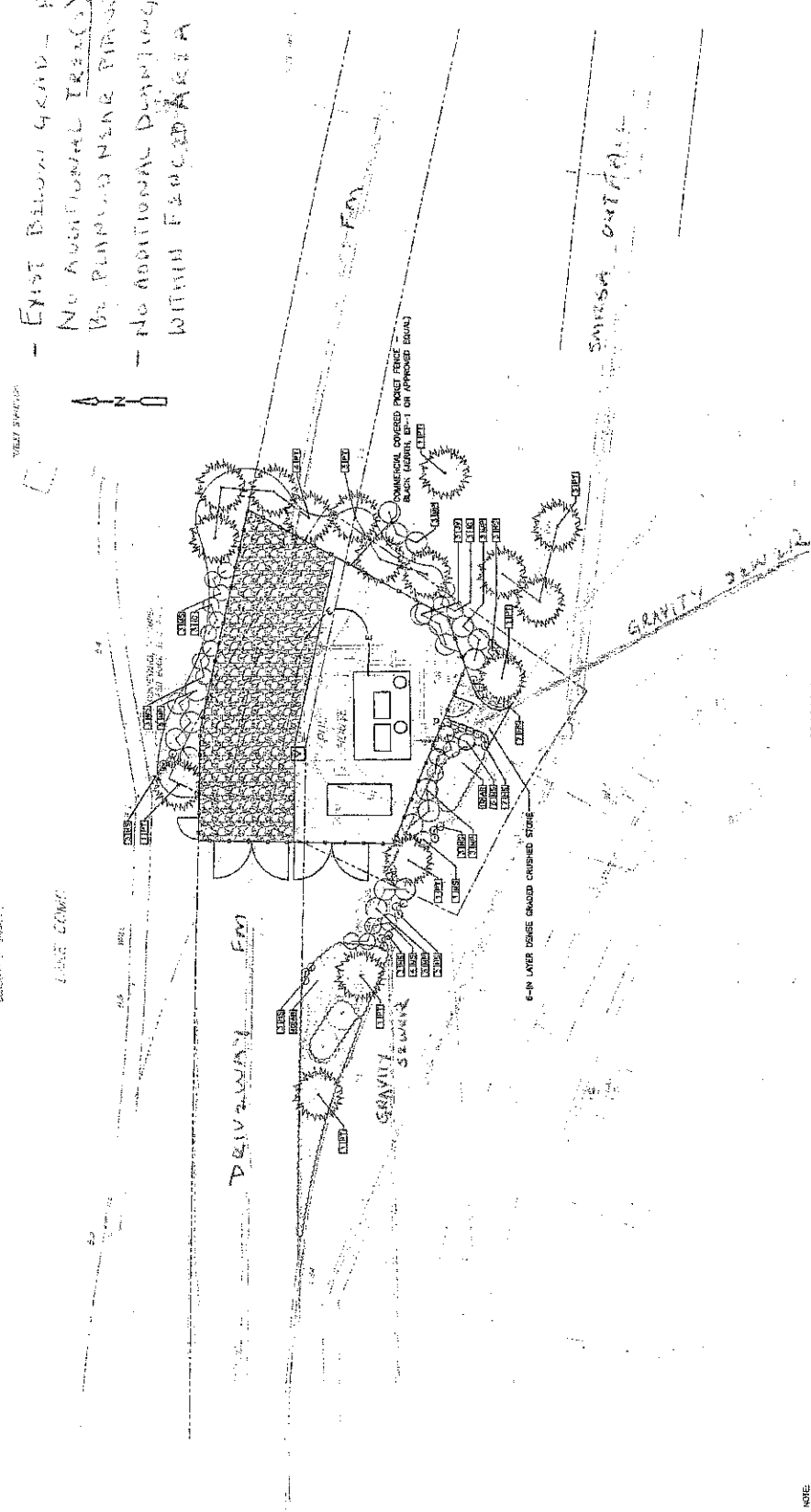

**PROPOSED PLAN**  
 1" = 10'

**LANDSCAPING PLAN**  
 L-1

**HOWARD MATTESSON**  
 PROFESSIONAL LANDSCAPE ARCHITECT  
 1000 BELLEVILLE AVENUE  
 BELMAR, NJ 07621  
 PHONE: 908.328.4444  
 FAX: 908.328.4444  
 PROJECT NO. 14111-10000  
 SHEET NO.

**SOUTH MONMOUTH REGIONAL SEWERAGE AUTHORITY**  
 BELMAR, NEW JERSEY  
**PITNEY AVENUE PUMPING STATION**  
 REHABILITATION

**CDM Smith**  
 CONSULTING ENGINEERS AND ARCHITECTS  
 1000 BELLEVILLE AVENUE  
 BELMAR, NJ 07621  
 PHONE: 908.328.4444  
 FAX: 908.328.4444

**DESIGNED BY:** M. J. JENSEN  
**CHECKED BY:** A. JENSEN  
**DATE:** 10/28/14

**REVISIONS:**

NO.	DATE	DESCRIPTION

**NOTE:** AREA (SET) REFERENCES REFLECT MAINSTAYS SURVEYS ONLY. SURVEYS ON THE PROPERTY DURING THE REVISIONS PERIOD SHALL BE PERFORMED ON OCTOBER 8, 2013.

## RESOLUTION # 50-16

### Approve Thomas Strong as a Full-time Permanent Employee of the South Monmouth Regional Sewerage Authority

**WHEREAS**, the South Monmouth Regional Sewerage Authority has previously hired Mr. Thomas Strong as an Operator Journeyman; and

**WHEREAS**, Mr. Strong has performed his duties as a probationary employee as required; and

**WHEREAS**, a positive 90 day Performance Evaluation has been given and recommendation is made that Mr. Thomas Strong should become a full-time permanent employee of the South Monmouth Regional Sewerage Authority.

**NOW, THEREFORE, BE IT RESOLVED** that Mr. Thomas Strong is hereby assigned as a full-time permanent employee of SMRSA effective May 1, 2016.

CERTIFIED TO BE A TRUE COPY OF A RESOLUTION  
DULY ADOPTED BY THE SOUTH MONMOUTH  
REGIONAL SEWERAGE AUTHORITY AT ITS REGULAR  
OPEN PUBLIC MEETING ON 05-12-16.

  
\_\_\_\_\_  
MARY L. BURNE, SECRETARY

## RESOLUTION #51-16

### Promotion of Thomas Strong to the Position of Shift Operator

**WHEREAS**, the Executive Director has consulted with departmental managers and subsequently recommends to the Board of Commissioners of the SMRSA that the need exists to fill a Shift Operator position; and

**WHEREAS**, after considering all potential and interested candidates the Executive Director recommends that Thomas Strong currently an Operator Journeyman be promoted to the position of Shift Operator to fill said vacancy; and

**WHEREAS**, it is desirable of the Authority to promote Mr. Thomas Strong to the position of Shift Operator.

**NOW, THEREFORE, BE IT RESOLVED** that the South Monmouth Regional Sewerage Authority approves the permanent placement and promotion of Thomas Strong as Shift Operator effective May 16, 2016, at the commensurate hourly wage as described in the aforementioned collective bargaining agreement.

**BE IT FURTHER RESOLVED** that the Executive Director is herein directed and authorized to facilitate all necessary changes in Mr. Strong's employment status to facilitate said promotion.

CERTIFIED TO BE A TRUE COPY OF A RESOLUTION  
DULY ADOPTED BY THE SOUTH MONMOUTH  
REGIONAL SEWERAGE AUTHORITY AT ITS REGULAR  
OPEN PUBLIC MEETING ON 05-12-16.

  
\_\_\_\_\_  
MARY L. BURNE - SECRETARY